

# Crosby® Alloy Bolt Type Shackles

**Load Rated**



**G-2140 / S-2140  
ALLOY  
BOLT TYPE  
ANCHOR SHACKLES**



G-2140 meets the performance requirements of Federal Specification RR-C-271D, Type IVA, Grade B, Class 3, except for those provisions required of the contractor. For additional information, see page 391.

- Quenched and Tempered.
- Alloy bows, Alloy bolts.
- Forged Alloy Steel 30 thru 175 metric tons. Cast Alloy Steel 200 thru 400 metric tons.
- Working Load Limit is permanently shown on every shackle.
- All sizes are individually proof tested to 2.0 times the Working Load Limit.
- Pins are galvanized and painted red.
- All sizes are **RFID EQUIPPED**.
- Shackles are Quenched and Tempered and can meet DNV impact requirements of 42 joules at -20 C.
- Crosby products meet or exceed all requirements of ASME B30.26 including identification, ductility, design factor, proof load and temperature requirements. Importantly, Crosby products meet other critical performance requirements including fatigue life, impact properties and material traceability, not addressed by ASME B30.26.
- Shackles 200 metric tons and larger are provided as follows.
  - Serialized Pin and Bow
  - Material Certification (Chemical)
  - Magnetic Particle Inspected.
  - Certification must be requested at time of order.
- Type Approval and certification in accordance with ABS 2006 Steel Vessel Rules 1-1-17.7, and ABS Guide for Certification of Cranes.

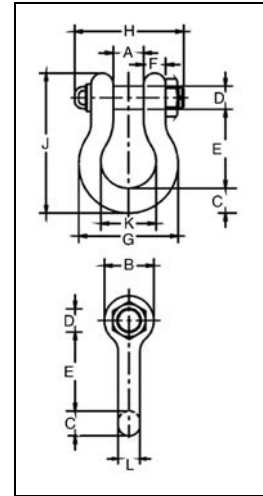

Nominal Shackle Size (in.)	Working Load Limit (t)*	Stock No.		Weight Each (kg)	Dimensions (mm)											Tolerance +/-	
		G-2140	S-2140		A	B	C	D	E	F	G	H	J	K	L	A	E
1-1/2	30	1021110	1021129	8.52	60.5	91.9	41.1	41.4	146	35.3	175	196	254	98.6	38.9	3.3	6.4
1-3/4	40	1021138	1021147	15.4	73.2	106	57.2	50.8	178	44.5	224	237	313	127	46.7	3.3	6.4
2	55	1021156	1021165	23.6	82.6	122	61.0	57.2	197	50.8	258	264	347	146	52.8	3.3	6.4
2-1/2	85	1021174	1021183	43.5	105	148	79.2	69.9	267	66.5	324	345	455	184	68.8	6.4	6.4
3	120	1021192	-	81	127	165	92.2	82.6	330	76.2	371	384	546	200	79.2	6.4	6.4
3-1/2	† 150	1021218	-	120	133	203	111	95.3	372	95.3	432	448	632	229	91.9	6.4	6.4
4	† 175	1021236	-	153	140	229	116	108	368	102	457	517	652	254	102	6.4	6.4
4-3/4**	† 200	1021414	-	204	184	267	152	121	397	95.3	533	539	743	279	114	6.4	6.4
5 **	† 250	1021432	-	272	216	305	165	127	508	98.6	622	576	889	330	114	6.4	6.4
6 **	† 300	1021450	-	352	213	305	171	152	495	129	635	637	895	330	127	6.4	6.4
7 **	† 400	1021478	-	500	210	356	184	178	572	165	660	728	1022	330	152	6.4	6.4

\* Note: Maximum Proof Load is 2.0 times the Working Load Limit. Minimum Ultimate Load is 4 times the Working Load Limit on 200 thru 400 metric Tons. For sizes 30 thru 175 metric Tons, Minimum Ultimate Load is 5.4 times the Working Load Limit.

\*\* Cast Alloy Steel.

† Furnished with Round Head Bolts with welded handle.

For Working Load Limit reduction due to side loading applications, see page 74.